



Yeelight Gateway

Instrukcja Obsługi

Product Description

Yeelight Gateway (BLE Mesh) is compatible with all Yeelight Bluetooth Mesh devices. Please add and manage Bluetooth Mesh devices via Yeelight App.

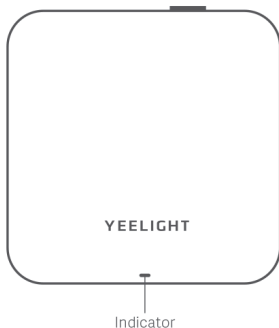
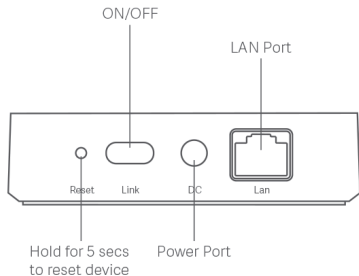

Indicator Status

Status	Indication
Red Light	Power on but failed to connect to the network
Green Light	Connected to WiFi network only
Blue Light	Power on and connected to WiFi and Mesh network
Blue Light Flashing Quickly	Connecting to network
Yellow Light Flashing Quickly	Waiting for pairing with app
Yellow Light Flashing Slowly	Updating Firmware
Red Light Flashing Quickly	Reset successful, and go to pairing after 2 flashes of red light

Setup Instructions

Do not put the gateway too close to wireless router. Recommended distance is 2 to 6 meters.

1. Power on the gateway and connect your mobile phone to the Wi-Fi network in 2.4GHz band.

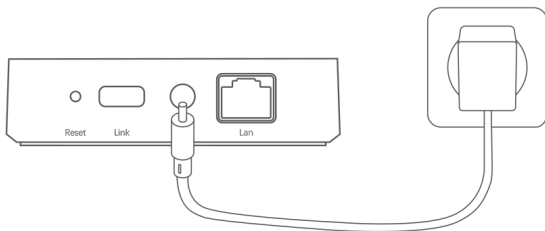

2. Open Yeelight App. Click "+" in the upper right corner, add the gateway according to the prompts, and connect it to the network. Alternatively, you can directly access the network through the LAN network port after adding the device in Yeelight App.



Search "Yeelight" in the app Store, or scan the QR code to download and install the Yeelight App.

3. After the gateway is connected to the network, any Yeelight Bluetooth Mesh device can be connected to the network through Yeelight App.

* Please keep mobile phone as close to the gateway as possible during connection, and ensure mobile phone and gateway are working under the same network.

How to Reset

Press the Reset button for 5 seconds till the yellow light flashes quickly, and then release the button. Reset is completed when green light is on.

* All the related Bluetooth Mesh lights or other devices (if any) should be reconnected to Yeelight App after the gateway is reset.

Apple HomeKit Smart Control

1. Open the Home app in your iPhone or iPad;
 2. Click "+" button and add accessory as per the prompts in the app. scan the QR code on the right or on the surface of the device. Alternatively, input the 8-digit code shown above the QR code to complete the access to Apple Home.
- * Make sure Wi-Fi network is available and you can access the internet normally. This device is not compatible with 5G network.
 - * To ensure proper HomeKit compatibility, iOS 9.0 or above is recommended;
 - * HomeKit Codes are indicated under the base of the device. The codes are required for reset every time.
 - * Apple is the trademark of Apple LLC.

Use of the Works with Apple badge means that an accessory has been designed to work specifically with the technology identified in the badge and has been certified by the developer to meet Apple performance standards. Apple is not responsible for the operation of this device or its compliance with safety and regulatory standards.

HomeKit is a trademark of Apple Inc., registered in the U.S. and other countries.

To control this HomeKit-enabled accessory, the latest version of iOS or iPadOS is recommended.

Home hub

A customer who owns an Apple TV (4th generation or later) with tvOS 10 or later, an iPad with iOS 10 or later, or a HomePod can control HomeKit-enabled accessories away from home and automatically through triggers such as time of day, location, sensor detection, or the action of an accessory.



Parameters

Model No. : YLWG01YL

Connectivity : Wi-Fi IEEE 802.11 b/g/n 2.4G, BLE

Operating humidity : 5%~95% RH

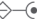
Operating Temperature : 0°C~40°C

Rated Input : 5V $\overline{=}$ 1A  

Rated Input(Adapter) : 100-240V AC, 50Hz/60Hz, 0.2A MAX

Package Contents: Gateway, USB Cable, User Manual

Safety Precautions

1. For indoor use only;
2. For safety, this device is recommended to use in any place where its altitude is below 2000 meters;
3. " $\overline{=}$ " The symbol indicates Direct Current (DC);

WEEE Disposal and Recycling

All products bearing this symbol are waste electrical and electronic equipment (WEEE as in directive 2012/19/EU) which should not be mixed with unsorted household waste. Instead, you should protect human health and the environment by handing over your waste equipment to a designated collection point for the recycling of waste electrical and electronic equipment, appointed by the government or local authorities. Correct disposal and recycling will help prevent potential negative consequences to the environment and human health. Please contact the installer or local authorities for more information about the location as well as terms and conditions of such collection points.





HomeKit

设置码

Manufacturer : Qingdao Yeelink Information Technology Co., Ltd.

Address : 10F-B4, Building B, Qingdao International Innovation Park, No.1 Keyuan Weiji
Road, Laoshan District, Qingdao City, Shandong Province, P.R.China

Learn more at: www.yeelight.com

Customer service: support@yeelight.com