

PG-9078说明书 80g米黄色特种纸,双面折页 尺寸: 630x142mm

正面



忍者无线游戏手柄
产品说明书(PG-9078)中文版

适用说明:

- 1.非常感谢您购买ipega公司开发生产的忍者无线游戏手柄;
- 2.产品主要适用于在Android/iOS/Win 7/8/10系统上无线连接时,进行游戏操作时使用!
- 3.适用设备:智能手机/平板电脑/智能电视机、机顶盒/PC电脑/P3游戏主机;
- 4.LT/RT为模拟量功能,更加注重体验的细节,使游戏精准可控!

★因第三方游戏平台软件升级或源代码变更等不可抗拒的因素造成部分游戏无法与本产品连接操作,我公司不承担任何责任。对此我公司保留最终解释权。

售后客服QQ群: 837350687
客服电话: 400-806-3006
在线时间: 周一至周五9:30-17:30



艾源格官方微信公众
(关注微信号 下载游戏大厅)

功能按键图示:

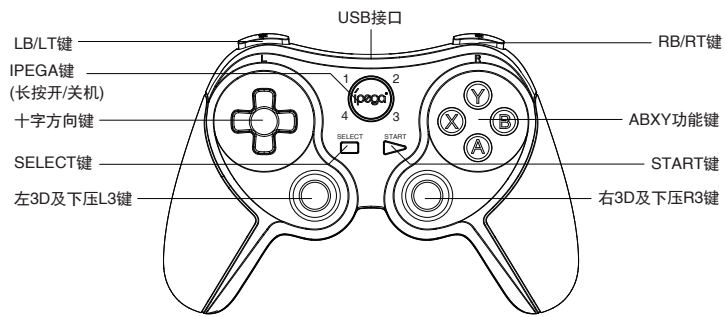

安卓设备使用说明:

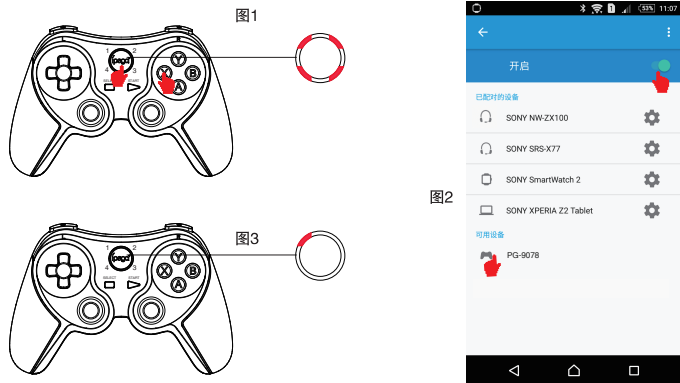

- 1.同时按住**X键**和**ipega键**2秒,此时四个LED指示灯同时快闪; 图1
- 2.将Android设备端的无线BT功能打开,点击“扫描”图2
- 3.当搜索到无线名为“PG-9078”的设备名时,选择配对连接; 图2
- 4.连接成功, LED1指示灯常亮! 图3
- 5.手机扫描说明书首页二维码关注艾源格官方公众号, 按提示下载并安装游戏大厅, 进入游戏大厅下载所需要的游戏。
- 6.推荐游戏:
 1. 穿越火线: 枪战王者
 2. 绝地求生: 全军出击
 3. 王者荣耀
 4. 魂斗罗: 归来
 5. 第五人格
 6. 荒野行动
 7. 小米枪战

iOS游戏大厅模式



支持iOS非越狱设备,支持第三方游戏平台(部分游戏平台可能需付费),此模式仅限中国大陆地区使用。

- 1.同时按住**X键**和**ipega键**2秒,此时四个LED指示灯同时快闪; 图1
- 2.将iOS设备端的无线BT功能打开,当搜索到无线名为“Newgamepad N1”的设备名时,选择配对连接; 图2
- 3.连接成功, LED3指示灯常亮; 图3
- 4.支持iOS设备9.3.0以上系统;
- 5.手机扫描说明书首页二维码关注艾源格官方公众号, 按提示下载并安装游戏大厅, 进入游戏大厅下载所需要的游戏。

P3游戏主机连接操作方法:

- 1.按住手柄START键使用包装附带的USB数据线直接与P3主机USB接口连接, 连接OK后, LED指示灯常亮;

PC有线连接操作方法:

- 1.按住手柄START键使用包装附带的USB数据线直接与电脑USB接口连接, 连接OK后, LED2指示灯常亮; 此时为PC模式。
- 2.需要长按**ipega键**三秒切换为360模式, 此时LED3指示灯亮。



无线连接PC设备操作方法

- 1.(带无线功能的电脑请直接跳至第4步)在手柄关机状态下, 同时按住手柄的**X键**与**ipega键**搜索无线设备, 此时LED1-LED4指示灯同时快闪;
- 2.将无线4.0以上接收器插入 PC设备的USB接口;Windows 系统会自动安装驱动程序;
- 3.驱动程序安装成功后,会在电脑的右下角显示无线设备的符号;如下图1;
- 4.将鼠标移动在无线符号处,单击鼠标右键,选择“添加设备”;如下图2;
- 5.选择“添加设备”后, 会在对话框内搜索到设备的型号(PG-9078)图标; 如下图3;
- 6.点击“下一步”, 并选择“不使用代码进行配对”, 确认后则会自动添加, 提示无线连接成功连接OK后, 指示灯常亮! 如下图4;
- 7.无线连接成功后为360模拟器模式; 支持以模拟器方式运行的游戏!

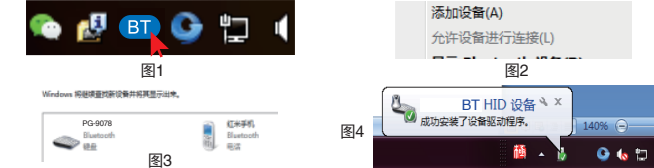

鼠标/多媒体功能

- 1.多媒体功能, 需在鼠标模式下进行操作,可控制音乐播放;
- 2.设备与手柄配对连接成功后,短按**ipega键**可切换至鼠标模式; 此时**LED2**灯亮;
- 3.在鼠标模式下,各按键功能如下(IOS系统设备因系统限制无鼠标功能,多媒体功能可正常使用):
Y键: 音量+; A键: 音量-; X键: 上一曲; B键: 下一曲; L2键: 播放/暂停; L1键: 鼠标左键;
R2键: 播放/暂停; R1键: 鼠标右键;左3D:鼠标快移动;右3D:鼠标慢移动;
- 4.如需切换回游戏模式请短按**ipega键**。

操作使用模式:

Android 系统		
	安卓标准游戏模式	鼠标模式
模式配对(长按2秒)	ipega+X	短按ipega
指示 灯	LED1	LED2
备 注	在无线连接的游戏模式下短按ipega键均可动态切换成鼠标模式	

	iOS 系统	Windows系统	
	iOS游戏大厅模式	USB有线模式	无线连接模式
模式配对(长按2秒)	ipega+Y	P360模式: 按住START键不放开机 360模式: P360模式下长按 ipega键 三秒进入	ipega+X
指示 灯	LED3	P360模式: LED2 360模式: LED3	LED1
备 注	支持iOS非越狱设备	需USB数据线	需无线适配器

电性参数:

- 1.工作电压: DC3.7V
- 2.工作电流: 30 mA
- 3.持续使用时:10H
- 4.静态电流: <35uA
- 5.充电电压/电流: DC5V/500mA
- 6.无线传输距离: ≤8M
- 7.电池容量: 380mAh
- 8.待机时间: 满电放置30天

手柄充电/休眠/唤醒功能:

- 1.手柄在没连接状态下充电时,4个LED指示灯同时慢闪,充电后熄灭!当在无线连接状态下充电时,当前模式灯慢闪,充电后长亮!
- 2.睡眠/唤醒功能: 游戏手柄在5分钟内不使用会进入休眠状态,当需要重新使用时需按ipega键唤醒即可回连;
- 3.电池电量不足时,当前模式指示灯快闪提示;

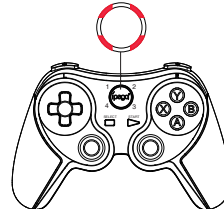

注意事项:

- 1.请不要把本产品放在潮湿或高温地方存储;
- 2.不要敲击、摔打、棒打、刺穿、或试图去分解本产品, 以免对产品造成不必要的损害;
- 3.产品内置电池, 请勿和垃圾一起丢弃;
- 4.不要在靠近火或其它热源的地方对手柄进行充电。
- 5.非专业人员拆卸勿本产品,否则不在售后保修服务内;

常见问题:

- 问: 为什么在iOS手机“App Store”里下载的游戏用手柄操控不了?
答: 因iOS的协议限制, iOS的游戏需在游戏平台内下载游戏, 平台内的游戏跟手柄适配过的, 之前已经下载的游戏要卸载, 以免有冲突)。
- 问: 游戏时按键不受控,或混乱怎么办?
答: 将手柄关机重新连接, 连接过程中请不要触碰其它按键
- 问: 手机无线打开无法搜索到手柄?
答: 1: 取消掉手柄与手机之前的无线配对设备名, 重新开启手机无线搜索配对
2: 使用回形针按下手柄背面的复位孔
- 问: 新手柄为什么不开机?
答: 1: 新手柄一般电量不足, 请用包装盒内的USB线接上5V充电器, 给手柄充电, 充满电后再按开机键开机。
2: 如果手柄接上电源(5V)后指示灯还是不亮, 请用回形针按下手柄背面的复位孔

配件清单:

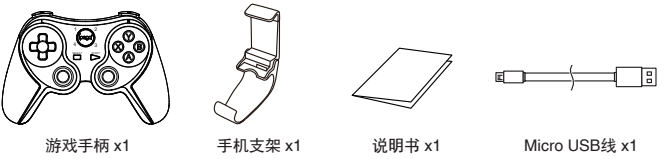

iPega 商标属于 PEGA LIMITED 所有。
ZL201730041694.8

反面



BT Gamepad User Manual
Instruction Manual(PG-9078)

Applicable instructions

- 1.Thanks for purchasing iPega developed BT GamePad.
 - 2.This product mainly compatible with BT enabled Android / Win 7 / Win 8 / Win 10 systems devices for gaming control.
 - 3.Applicable devices: Smartphone, tablet, smart TV, set-top box, windows PC, P3 game console;
 - 4.LT button and RT button have simulator function, much more focus on operating details, make games controlled exactly.
- ★Due to the official game platform software upgrades or source code changes and other not resist factors caused some of the game can not be played or connected with our Gamepad, iPega company has no responsibility.iPega reserve the right of final interpretation for this.
- ★**iOS devices (iPhone/iPad) has authorization limited, so currently for Chinese user only.**

Introduction for key functions:

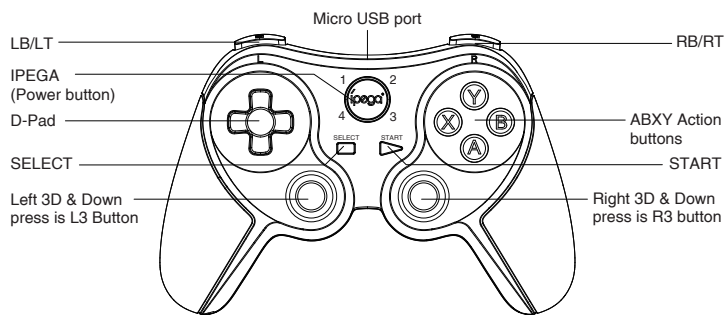

Usage of Android device

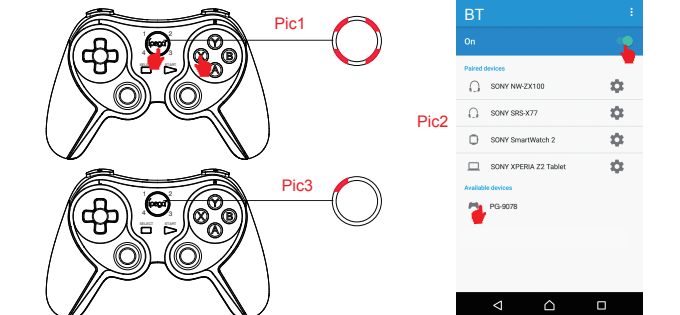

1. Press and hold **X** button + **ipega** button for 2 seconds at the same time, 4 LED indicator lights will blink simultaneously in a rapid manner at this moment.Refer Pic1
- 2.Open the BT on Android device, click searching, find and select “PG-9078” for BT pairing. Refer Pic2
3. LED1 lit on after BT connected. Refer Pic3
- 4.Then you are ready for playing games on Android devices.

Important notice for games capability in this mode:

- 1.Download simulator games from the third party Games App. Scan the QR code or input www.xiaoj001.com to your phone browser to download the Android Game Center App, there has vast of most popular available games supportable.
- 2.Download gamepad enabled games (similar console games as below) from Google Playstore which you can play directly. You can map button in the game settings for some of the game, such as ShadowGun. Recommend console game list: Implosion / Dead Trigger / Dead Effect / SoulCraft - Action RPG / Dungeon Hunter 5 - Action RPG / Shadowgun: DeadZone.
- 3.If you want play some of the online games such as PUBG, Mobile lenges, Rules of survival etc which downloaded from Google Playstore, then you need download the Octopus driver for buttons mapping, check the operation guide video on PEGA HK Youtube.

Scan to download
Android Game Center:



www.xiao-
ji001.com



Octopus Driver:
http://www.phoenixos.
com/octopus/intro

Usage of P3 game console by using USB data cable connecting:

- 1.Press on the START key on gamepad and connect it to the P3 console's USB port via the USB cable. After connected, LED light is on.

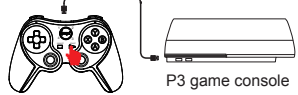

Usage of Windows PC by using USB data cable connecting:

- 1.Press on the START key on gamepad and connect it to the computer's USB port via the USB cable. After connected, LED2 light is on, it is PC mode.
- 2.Press on the **ipega** key for 3 seconds to switch to 360 mode(X-input mode), LED3 light is on.

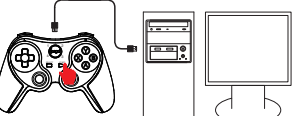

How to connect PC device with BT:

1. Press and hold **ipega + X** button for 2 seconds until LED flash quickly, which means game controller entered into BT searching.(If your PC has BT function, please go to step4)
- 2.Insert the BT 4.0 or above dongle (not in the package) into the USB interface on PC device; The driver will be installed by Windows system automatically;
3. After the driver is installed successfully,the symbol of the BT device will be displayed in the lower right corner of the computer.
4. Move the mouse to the BT symbol, click the right mouse button,and select “Add device”.
5. After selecting “Add device”, the device model (PG-9078) icon can be searched.
6. Click “next”, and select “Do not use the code to match”, it will be automatically added after confirmed , then remind the BT was connected! After connected, the indicator light is always on.
7. It will be D_INPUT mode after the BT is connected successfully and can support the games running in simulator way.

Mouse & Multimedia Function

1. Multimedia player function, need to operate in mouse mode;
2. After successful connection in HID mode, you can switch to mouse mode by short press **ipega** key; LED2 lights up at this time;
3. In mouse mode:
Y key: volume +; A key: volume -; X key: previous song; B key: next song; L2 key: play/pause;
L1 key: left mouse button; R2 key: play/pause; R1 key: Right mouse button; left 3D: mouse fast moving; right 3D: mouse slow moving.
4. Short press **ipega** key if you want switch back to HID made from mouse mode.

Operation instructions:

Android system		
	HID Mode(GamePad)	Mouse Mode
BT pairing buttons (Press and hold on 2's)	ipega+X	Under HID mode, press ipega button
Indicator	LED1	LED2
Remark	Press ipega button swift to mouse mode from HID mode	

Windows system		
	USB Wired Mode	BT connections to Gamepad Mode
BT pairing buttons (Press and hold on 2's)	Press the START key to power- on the PC mode;press ipega for 3 seconds to enter the Xinput mode	ipega+X
Indicator	P3 mode: LED2 X-input mode: LED3	LED1
Remark	A USB data cable needed	A BT dongle needed if PC has no BT function

Electrical Parameters:

- 1.Working voltage: DC3.7V
- 2.Working current: 30 mA
- 3.Consecutive Usage Hours: 10H
- 4.Static current: <35uA
- 5.Charging voltage/current: DC5V/500mA
- 6.BT transmission distance: ≤8M
- 7.Battery capacity: 380mAh
- 8.Standby time: up to 30days once fully charged

Charge/ Sleep/ Wake up function of Gamepad:

1. When the gamepad is not connected to any device while it is charging, 4 LED indicator lights will slowly blink. When the charging is completed, the lights will be off. When the gamepad is connected to other device via BT while it is charging, the current mode light will slowly blink. When the charging is completed, the light will be on.
2. Sleep/Wake-Up Function: The game pad not be used within 5 minutes and it will enter into the sleep status. When you need to use it again, press the ipega key For 2 seconds and it will automatically return to wake-up status.
3. When the battery power is low, the current mode indicator light will blink rapidly.

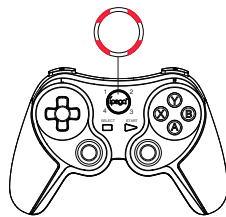

Notes:

1. Please do not store this product in wet or high-temperature areas.
2. Don't knap, beat, burn, pierce, or try to decompose this product, to avoid unnecessary damage to the product.
3. The product has built-in batteries, and please don't discard them together with the garbages.
4. Don't charge the controller in a place near the fire or other heat source.
5. Non professional personnel should not disassemble the product, otherwise it will not be covered in the after-sales warranty service.

Frequency asked question to operate this Gamepad

Q1: I opened BT searching, but still can't pair it with my device?
A1: Please turn off and ignore the previous connected device. Then reopen BT for connect. If you still can't connect, then please use the needle press the RESET button on the back of Gamepad for 5 seconds. Then reconnect the BT.

Q2: I can't turn on the Gamepad.
A2: Please recharge the Gamepad before you use it at the first time or use it again after a long period. Please check the charge indicator light turn on while charging and will turn off once fully charged. If the Charge indicator do not light on while charge cable connected to the power source, then please try to change a charge cable or use the needle press the RESET button on the back of Gamepad for 5 seconds.

Q3: Joystick moving itself or other buttons works improper when entered the game.
A3: Please use the needle press the RESET button on the back of Gamepad for 5 seconds. Please be reminded don't touch wrong buttons while BT pairing.

Accessories List

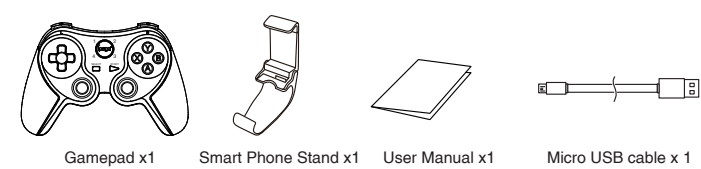

iPega trademarks belongs to PEGA LIMITED.
ZL201730041694.8